



## 38 The Belfry, Luton, LU2 7GA

A stunning two bedroom house located on The Belfry, Bushmead, presented in mint condition throughout. The property has been completely renovated to a high standard, offering modern, stylish living in a desirable residential area.

The accommodation comprises a bright and spacious living area, a contemporary fitted kitchen, two well proportioned bedrooms, and a modern bathroom. Finished with neutral décor and new flooring throughout, the home is ready for immediate occupation.

Further benefits include a private rear garden, ideal for outdoor relaxation, and a convenient location close to local amenities, well regarded schools, and excellent transport links.

Available to rent immediately and ideal for professionals, couples, or a small family looking for a high-quality home in the popular Bushmead area of Luton.

- Nova Estate Agents
- Press Play Button For 360° Walkaround Tour
- Private Garden
- Newly Renovated
- Two Bedrooms
- Popular Bushmead Location
- Available Now!

£1,250 Per month

Approx Gross Internal Area  
45 sq m / 480 sq ft

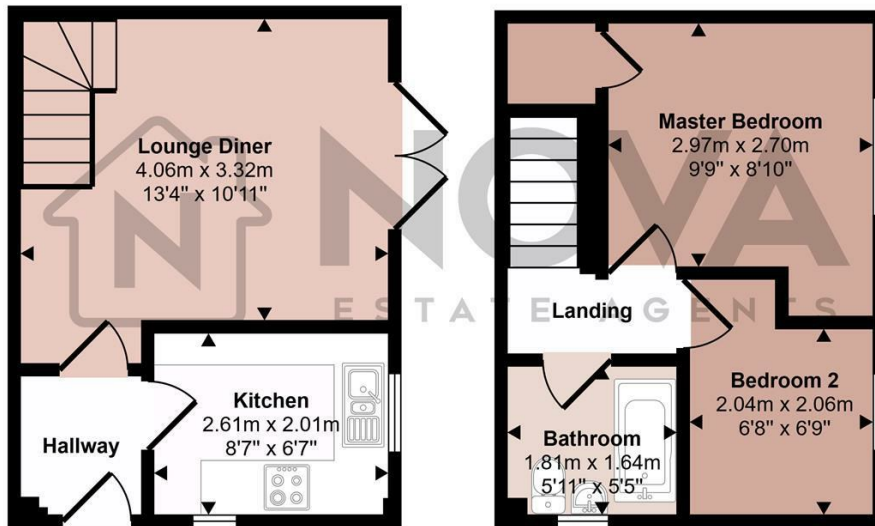

Ground Floor  
Approx 22 sq m / 241 sq ft

First Floor  
Approx 22 sq m / 239 sq ft

This floorplan is only for illustrative purposes and is not to scale. Measurements of rooms, doors, windows, and any items are approximate and no responsibility is taken for any error, omission or mis-statement. Icons of items such as bathroom suites are representations only and may not look like the real items. Made with Made Snappy 360.

